

KEY:

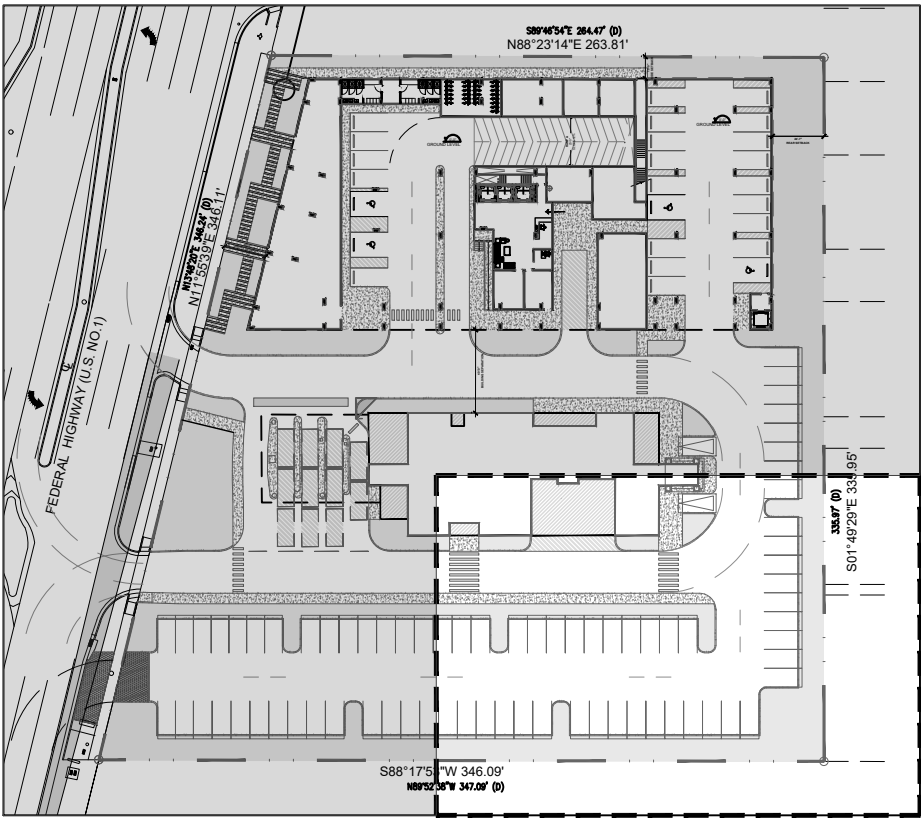

absolute-idea.com
CANAL PARK
3323 NE 163rd Street, Suite 200 North Miami Beach, FL 33160
305.792.0015 305.931.0279 info@absolute-idea.com

SEAL
KEN GARDNER
FLA 1589
TO THE BEST OF MY KNOWLEDGE, THE PLANS AND SPECIFICATIONS CONTAINED HEREIN WERE PREPARED BY ME OR UNDER MY CLOSE PERSONAL SUPERVISION AND I AM A PROFESSIONAL ENGINEER AS DEFINED BY THE FLORIDA STATUTES IN ACCORDANCE WITH THE SECTIONS HEREIN AND AS REQUIRED.

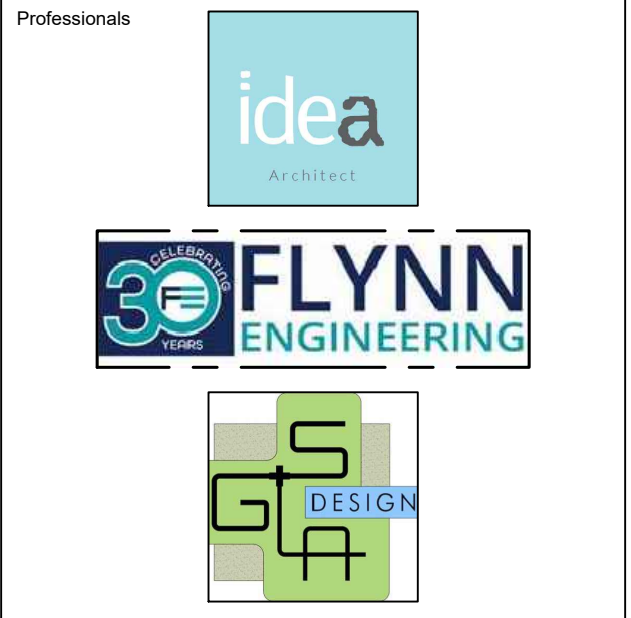

| REV. | DATE | DESCRIPTION |
|------|------------|----------------|
| 01 | XX-XX-2024 | D.R.C SUBMITAL |
| | | |
| | | |
| | | |
| | | |
| | | |
| | | |
| | | |

ALL MEASUREMENTS MUST BE VERIFIED BEFORE BEGINNING THE WORKS. NO MEASUREMENTS ARE TO BE SCALED DIRECTLY FROM THIS DRAWING.

Key section
PROGRESS SET

Client
VERA FUND
NICK POLYUSHKIN
& YURI KHARITONENKOV
TEL: 305.833.3303

Project
**1600 S FEDERAL HIGHWAY
(MIXED-USE PROJECT)**
1600 SOUTH FEDERAL HIGHWAY,
POMPANO BEACH, FL 33062

| Title | |
|---|---|
| PLANTING PLAN GROUND FLOOR | |
| Drawn GSLA KG Approved KG | Field LANDSCAPE ARCH Scale as shown Date 10-09-2024 Dwg. no. L-204 |
| Project PZ24-12000027 11/19/2025 24-838 | |

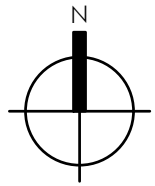

PLANTING PLAN - GROUND FLOOR

SCALE: 1" = 10'